

## BUSINESS &gt; REAL ESTATE

# Tractor Supply Co. coming to new Four Corners retail center along US 27

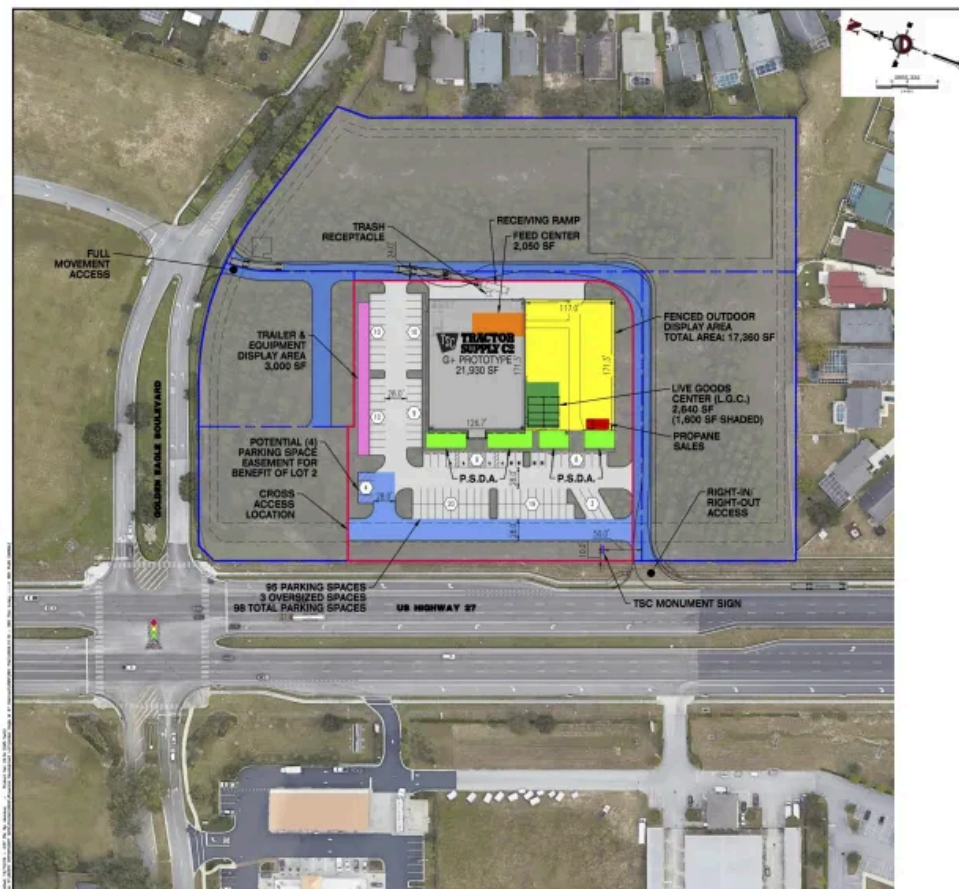

A site plan for the 10-acre mixed-use retail center in the Four Corners area, showing the Tractor Supply location and associated properties within the development. (Site plan generated by Dynamic Engineering Consultants)



By **JAMES WILKINS** | [twilkins@orlandosentinel.com](mailto:twilkins@orlandosentinel.com)

UPDATED: May 23, 2025 at 2:24 PM EDT

---

With construction already underway on the 10-acre retail center along U.S. Highway 27, developer Elevation Golden Oaks has lined up a new Tractor Supply Co. location to fill out the site.

A joint venture between Orlando-based [Harbco Development](#) and [Elevation Development](#), Elevation Golden Oaks will be developing the Tractor Supply store as part of their mixed-use retail center at the intersection of US 27 and Golden Eagle Blvd. in the Four Corners area of Lake County.

Elevation Development purchased the site for \$3.5 million in January 2024 and [broke ground in August](#). Along with Tractor Supply, other retail locations within the development will include a Big Dan's Car Wash, Extra Space Storage facility, Chase Bank and a daycare center.

At 21,930 square feet, the Tractor Supply will also include a 20,000-square-foot fenced outdoor display area and 3,000-square-foot trailer display area. Associated site improvements — landscaping, grading, stormwater and utility infrastructure among others — will bring the total project area to 3.31 acres, according to Harbco Development CEO Tom Harb.



The retail center will have a car wash, self-storage facility, a bank, and a daycare. A Tractor Supply Co. store will take over the two available pads in 2026. (Courtesy of JLL)

“We’re going to be doing the pavement, obviously,” Tom Harb, CEO of Harbco Development said. “We already have a master retention pond done and we already have the service roadway done, so the only thing we’re going to be doing now is the parking lot and the vertical building.”

Harb said he expects construction on most of the site to be complete by the end of the summer, with Tractor Supply to break ground by “late this year or early next year.”

“We are very proud of this development; it came together very well,” he said. “I think it will create a lot of revenue for the county, probably over \$35 million in investment overall. It will create a great value for the county in tax revenue.”

Another Tractor Supply location is currently under construction at [SunRay Junction West](#), a retail center in the Kissimmee area, a block from the Poinciana SunRail station.

Tractor Supply Co., based in Brentwood, Tenn., was founded in 1938. The company's stores offer products for home improvement, agriculture, lawn and garden maintenance, and livestock, equine and pet care. Last year, the company opened 80 new stores, bringing the total number of stores to over 2,500 across 49 states. This year, the company plans to open 90 new stores, according to its [annual report](#).

Tractor Supply is the latest retailer heading to Clermont. Next door, WMG Development recently completed a new McDonald's, Mavis Tire store and dental office. In January, [Sprouts Farmers Market filed plans](#) for a new grocery store on the U.S. 27 corridor, and [White Castle](#) recently broke ground on its second Orlando-area burger restaurant at Plaza Collina.

*Have a tip about Central Florida development? Contact me at [jwilkins@orlandosentinel.com](mailto:jwilkins@orlandosentinel.com) or 407-754-4980. Follow GrowthSpotter on [Facebook](#) and [LinkedIn](#).*

*Originally Published: May 23, 2025 at 2:15 PM EDT*

**2025 > May > 23**